

KRL

Radial flow diffuser

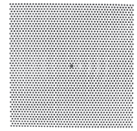
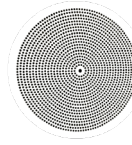

5.6

5 RADIAL FLOW DIFFUSER

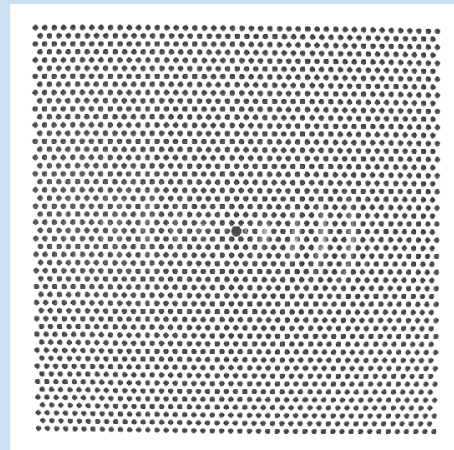
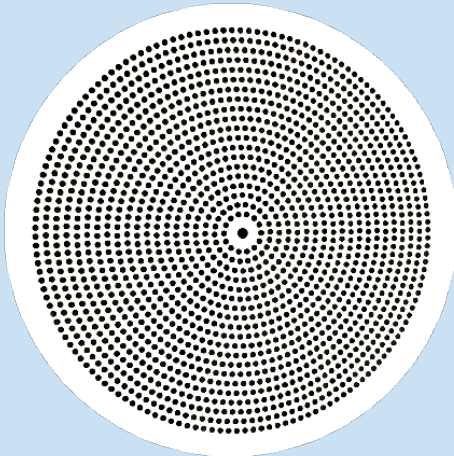
**Design:**

The diffuser KRL is a radial flow diffuser with a perforated front casing. The air control is achieved using fixed, diffuser-like shaped air guiding elements to generate radial horizontal streams. The front-sided perforation provides an even blow-out characteristic. The special construction assures a high throughput of air at low sound power levels. The mounting of the front plate is done via central screw fastening.

Function:

The diffuser-like shaped, fixed air guiding elements generate a horizontal radial flow with low induction. That way stream velocity and differences in temperature are fast reduced.

Material:

The front plate is made of galvanised, perforated thin sheet coated in white (RAL 9010). The air guiding elements behind are made of steel coated in matt black.

Accessories & Options:

- Plenum box with horizontal spigot
- Plenum box with vertical spigot
- Perforated sheet throttle within spigot
- Special perforation

KRL

Radial flow diffuser

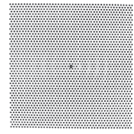
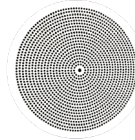

Dimensions

KRL-RZ...

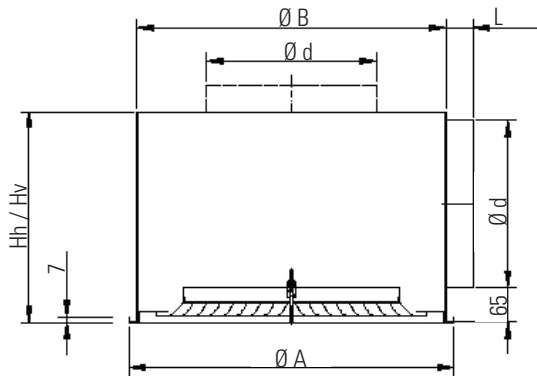
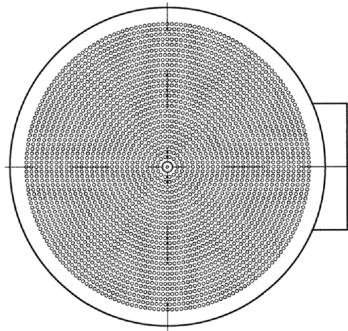

KRL-QZ...

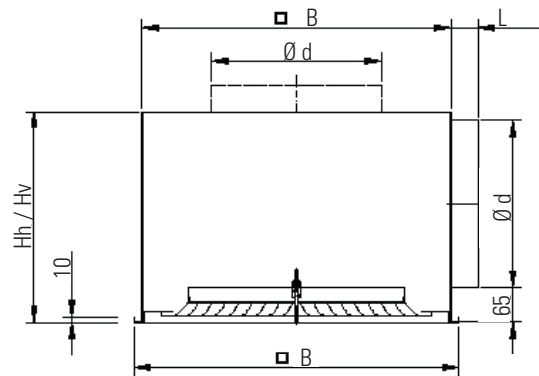

Size	□ A / Ø A [mm]	□ B / Ø B [mm]	Hh [mm]	Hv [mm]	Ø d [mm]	L ¹⁾ [mm]
300	300	270	205	200	123	105
400	400	370	280	200	198	160
500	500	470	330	250	248	200
600 / 620 / 625	600	570	395	300	313	200

The dimensions given are external dimensions [mm] and can be varied within functional technical limits depending on the requirements.

Hh = Height with horizontal connection, Hv = Height with vertical connection

¹⁾ Nozzle length without throttle always 50 mm

KRL

Radial flow diffuser

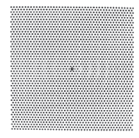
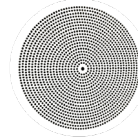

5.6

Air technical data KRL-QZ

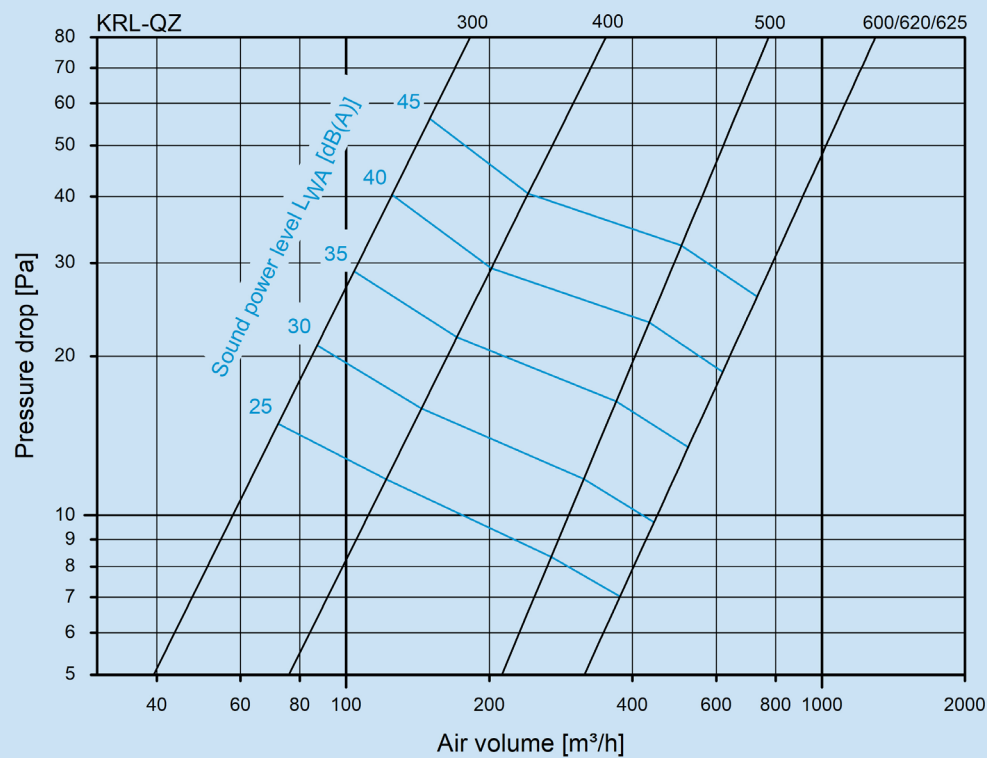

Quick selection

Size	$L_{WA} = 25$ dB		$L_{WA} = 30$ dB		$L_{WA} = 35$ dB		$L_{WA} = 40$ dB		$L_{WA} = 45$ dB	
	V [m³/h]	Δp [Pa]	V [m³/h]	Δp [Pa]	V [m³/h]	Δp [Pa]	V [m³/h]	Δp [Pa]	V [m³/h]	Δp [Pa]
300	72	15	87	21	104	29	125	40	150	56
400	122	12	144	16	171	22	202	29	242	41
500	270	8	316	12	370	16	434	23	507	32
600	377	7	444	10	524	13	619	19	731	26

KRL

Radial flow diffuser

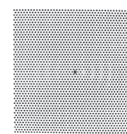
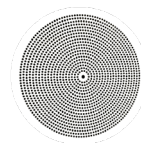

Air technical data KRL-RZ

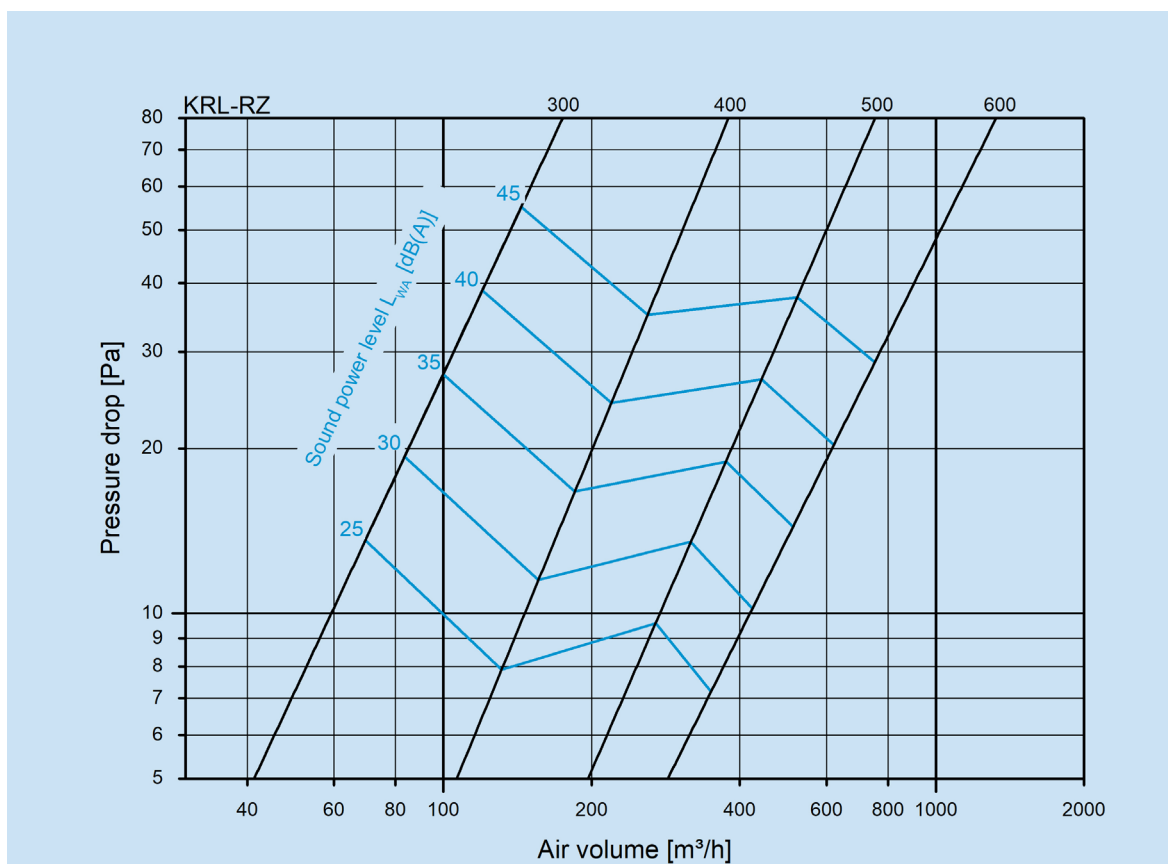

Quick selection

Size	$L_{WA} = 25 \text{ dB}$		$L_{WA} = 30 \text{ dB}$		$L_{WA} = 35 \text{ dB}$		$L_{WA} = 40 \text{ dB}$		$L_{WA} = 45 \text{ dB}$	
	V [m³/h]	Δp [Pa]	V [m³/h]	Δp [Pa]	V [m³/h]	Δp [Pa]	V [m³/h]	Δp [Pa]	V [m³/h]	Δp [Pa]
300	70	14	84	19	100	27	120	39	144	55
400	132	8	156	12	185	17	220	24	260	35
500	270	10	318	14	375	19	443	27	523	38
600	350	7	424	10	513	14	620	20	753	29

KRL

Radial flow diffuser

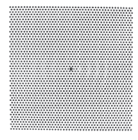
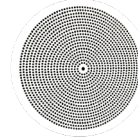

5.6

5 RADIAL FLOW DIFFUSER

Tendertext

KRL-QZ ☐ Square shaped radial flow diffuser with perforated front casing, with fixed, diffuser-like shaped air guiding elements for generating radial horizontal streams. The front plate is perforated for an even blow-out characteristic and is made of galvanised thin sheet coated in white (RAL 9010). The air guiding elements are made of steel coated in matt black.

KRL-RZ ☐ Round shaped radial flow diffuser with perforated front casing, with fixed, diffuser-like shaped air guiding elements for generating radial horizontal streams. The front plate is perforated for an even blow-out characteristic and is made of galvanised thin sheet coated in white (RAL 9010). The air guiding elements are made of steel coated in matt black.

AK/H ☐ Plenum box with horizontal spigot, made of galvanised steel

AK/V ☐ Plenum box with vertical spigot, made of galvanised steel

D ☐ Perforated sheet throttle within spigot, galvanised; used by tape tension

Manufacture SLT · Lenzfeld 8 · D - 49811 Lingen (Ems)
Tel. +49(0)591/97337-0 · Fax +49(0)591/97337-50 · info@slt-lingen.de

Type KRL -

Quantity Stück

Ordering example KRL - Q Z - 600 - AK/H - D

